

Handle

1. Set **Units** to **Centimeters**
2. Open “**handleINL811**” from **Share > Hanson Middle > World of Tech > ProDesktop > Handle**
3. **File > Save Copy As.** Navigate to your **Bottle** folder in **World of Tech** folder. Save as “**handleINL811**”, replacing **INL** with *your initials*, and **811** with *your class number*.
4. Close “**handleINL811**”.
5. Open your copy of “**handleINL811**” from your **Bottle** folder.
6. **Right Click** on the **Frontal** workplane. Create a **New Sketch** and name it “**handle**”.

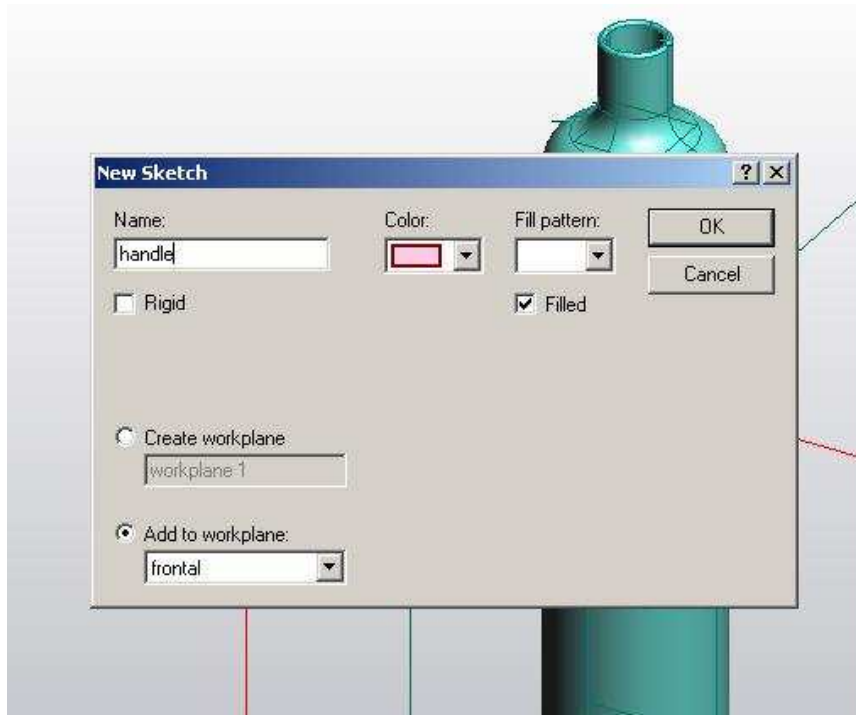

7. **Shift –W** to view onto workplane.
8. Sketch your “**handle**” using concentric ellipses, as below. Tip: you don’t need to use ellipses – you can create a freehand sketch, use rectangles or circles. The point is to create a valid sketch that looks like a handle.

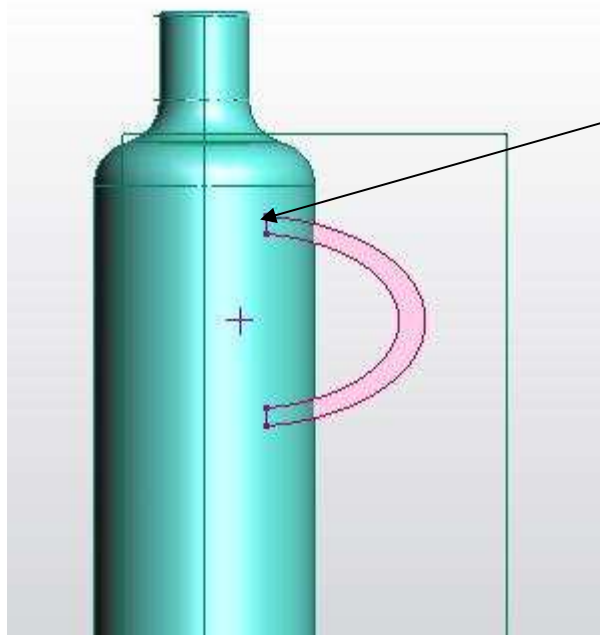

Your sketch should overlap the bottle side. Don't worry that will be inside of the bottle - when you shell out the bottle, the material will be removed.

9. **Extrude** the handle to 1 **cm**. Name the extrusion **extHANDLE**. Notice that you need to extrude **symmetric about workplane**, with a **15 degree taper angle**.

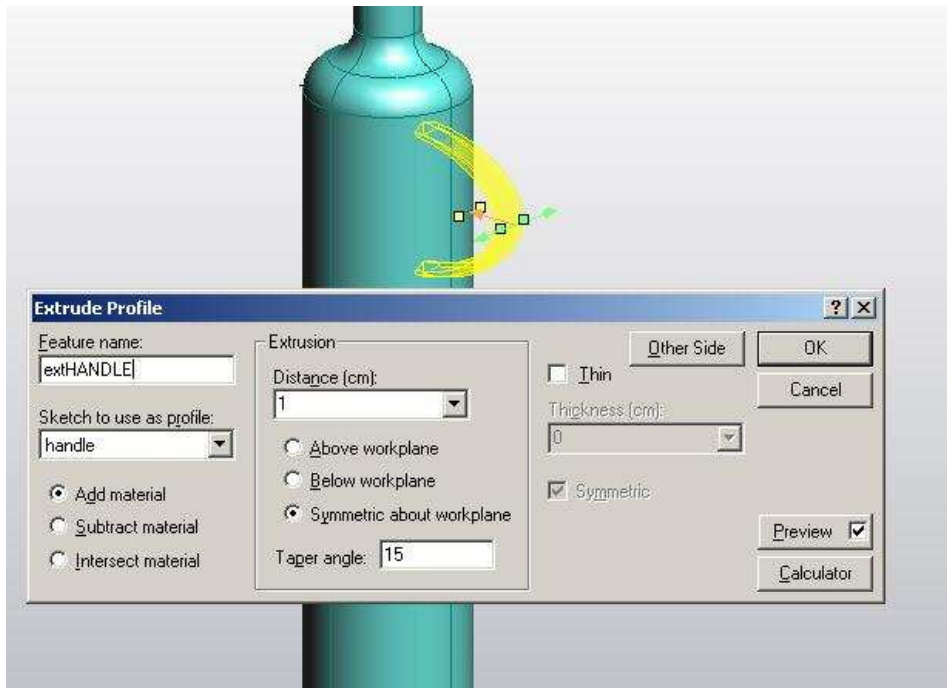

10. Your practice bottle with handle should look like the one below.

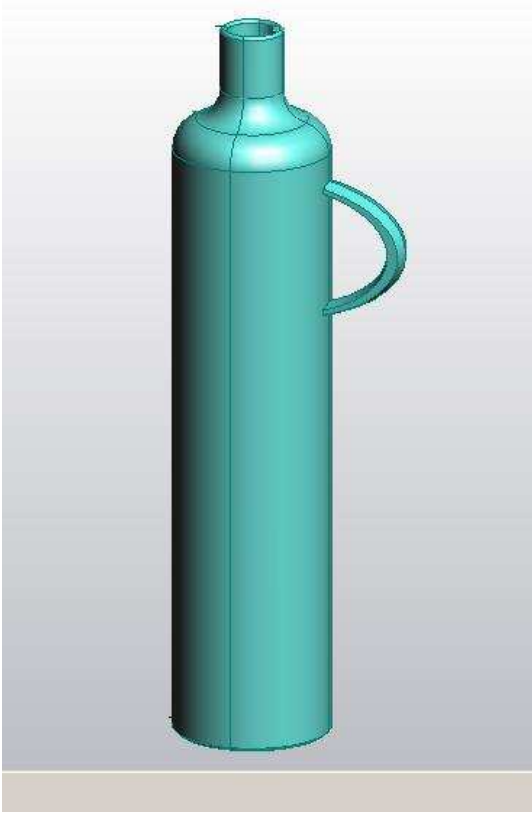

*****If you re-order your “shell” feature, the parts of the handle on the inside of the bottle will be shelled out!!***